

Electric Pizza Oven



Asber AEPO series ovens are a great choice for fresh-dough pizza, prebaked crusts, flat breads, pretzels, and other bakery products. We offer one baking chamber with **two ceramic decks** and three positions. Featuring Meteorite™ ceramic decks that achieve maximum heat while using less energy and providing quicker recovery times between uses, especially during peak business hours.

- Non-ferrous stainless-steel construction including front, top, sides and valve control panel.
- Porcelain door liner.
- Electrical resistance heating, controlled by an electromechanical thermostat from 250 °F to 700 °F, ANSI/CSA certified.
- Double wall construction with heavy insulation for fuel efficiency and Refrigerator exterior surfaces.
- Removable knobs and panel for easy maintenance.



AEPO-26-E

| MODEL | POWER (Kw) | AMPS | VOLTS - FREQUENCY | INTERIOR DIMENSIONS | | | DIMENSIONS | | | SHIPPING WEIGHT (lbs) |
|-----------|------------|------|------------------------|---------------------|---------|--------|------------|---------|---------|-----------------------|
| | | | | Width | Depth | Height | Width | Depth | Height | |
| AEPO-26-E | 3.6 | 16.3 | 230V. - I+N - 50/60Hz. | 22 1/4" | 20 5/8" | 8 1/4" | 26" | 29 3/8" | 19 3/4" | 205 |

Height includes legs. 2. Specifications are subject to change without prior notice.

Electric Pizza Oven



AEPOE-26 TOP

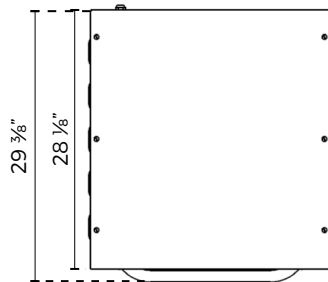

AEPOE-26 FRONT

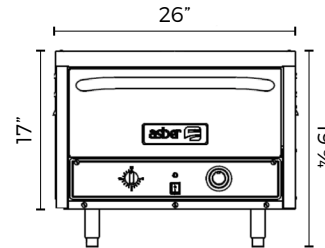

AEPOE-26 FRONT INTERIOR

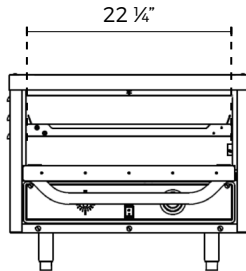

AEPOE-26 SIDE

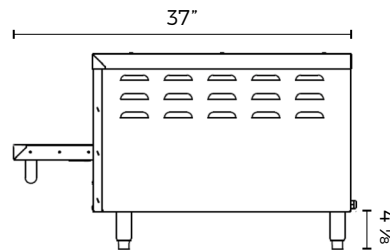

AEPOE-26 SIDE INTERIOR

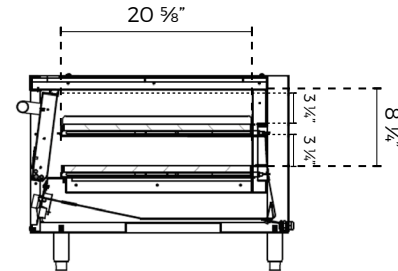

| DATA | AEPOE-26 |
|----------------------------------|----------|
| Power (Kw) | 3,6 |
| Amps | 16.3 |
| Frequency | 50/60Hz. |
| Volts | 230 |
| Shipping Weight (lbs) | 205 |
| DIMENSIONAL DATA | |
| Ext. Width Overall | 26" |
| Ext. Depth Overall | 29 3/8" |
| Ext. Height Overall ¹ | 19 3/4" |
| OVEN | |
| Interior Length | 22 1/4" |
| Interior Depth | 20 5/8" |
| Interior Height | 8 1/4" |

1. Height includes legs.

Standard Features

- Non-ferrous stainless-steel construction including front, top, sides and control panel.
- Porcelain door liner.
- 230V. electrical resistance heating.
- (2) ceramic decks included.

Warranty

- 1-year parts & labor.

*RESIDENTIAL APPLICATIONS: Asber assumes no liability for parts or labor coverage for component failure, factory defect or any other damages for units installed in non-commercial foodservice or residential applications.

INSTALLATION REQUIREMENTS

1. VENTILATION: An adequate ventilation system is required for commercial cooking equipment. Review local regulations to see specifications or in the absence of this review, www.NFPA.org.

2. CLEARANCE: 3" on the sides and the back for fuels and 0" for non-combustible constructions. It must be installed with legs of 4" minimum.